

# MEETINGS & EVENTS

HOTEL

EVENTS

- 146 total rooms
- 25 suites
- Custom curated art in each room
- Rotating gallery experiences from local artists throughout
- 24/7 fitness center
- Commonwealth Restaurant + ArtBar rooftop lounge

- 
- 8 artful + flexible spaces
  - Can seat groups of 3-300
  - In-house AV options
  - Custom catering packages
  - Full-service experience from layouts to linens

# MEETING SPACE

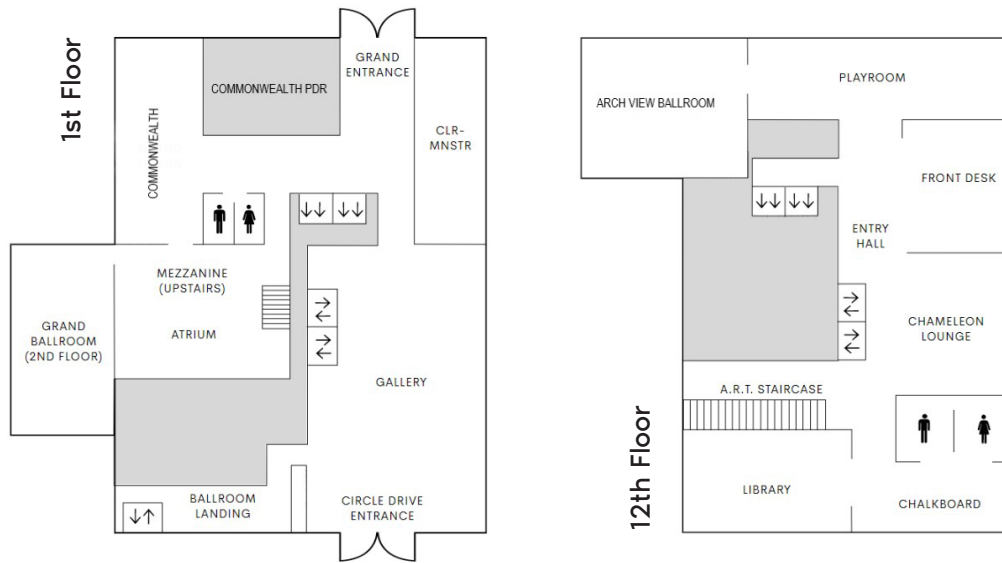

	Dimensions	Ceiling	Square	Seated	Standing	U-Shape	Conference	Classroom	Theater
Grand Ballroom	88'x35'	12'	3080	200	320	88	74	130	320
Arch View Ballroom	61'x43'	10'	2623	120	200	28	28	100	70
South Deck (Roof Top)	32'x42'	Open	1344	80	100				
Mezzanine	19'x45'	8'	855	45	60				48
Atrium	Flow	20'	961	75	100		24		30
Mezzanine + Atrium	Flow		3019	120	160				
Library Boardroom	22'x17'	10'	375	12			12		
Commonwealth Private Dining Room	19'x21'	15'	399	12			12		

\*\*If space is blank, the indicated style of set up is not conducive to the space.

SCAN TO TAKE A VIRTUAL TOUR

